

11231 NW 20th St

- Sweetwater, Florida 33172

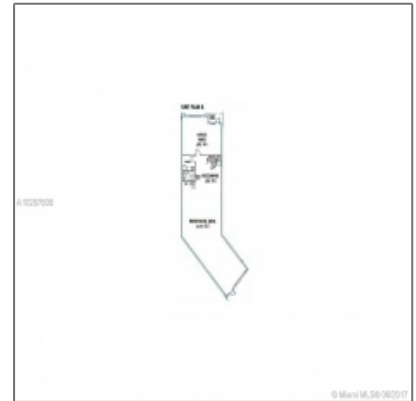

Basic Details

Property Type: **Commercial Property**

Prop Type/Type of Building: **Office/warehouse combination**

Listing Type: **For Sale**

Listing ID: **A10287608**

Price: **\$660,000**

View: **Garden view, other view**

Year Built: **2008**

Lot Area: **2,597 Sqft**

Unit Number: **123**

Status: **Active**

Address Map

Country: **US**

State: **FL**

County: **Miami-Dade County**

City: **Sweetwater**

Zipcode: **33172**

Features

#Stories: **2**

#Buildings: **1**

#Floors: **2**

Parking

Construction Type: **Concrete block construction**

Roof: **Concrete roof**

Additional Information

Area: **30**

Parcel Number: **25-30-31-046-0230**

Tax Amount: **\$9,961**

Tax Year: **2016**

Elementary: **Coconut grove**

School:

Middle School: **Ponce de leon**

Senior High School: **Coral springs**

Price/SqFt: **\$254**

Lot Sq Footage: **2,597 Sqft**

Addresson Internet: **1**

Agent Info



Jiovanny Restrepo

☎ +1 (786) 760-1077

✉ mail@jio.realtor

+1 (786) 760-1077 - 1335 Lincoln Rd. Miami Beach, FL 33139
