

- Doral, Florida 33172

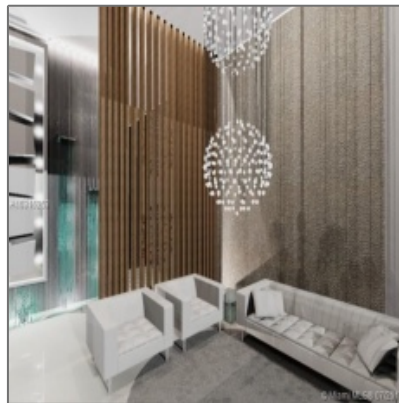
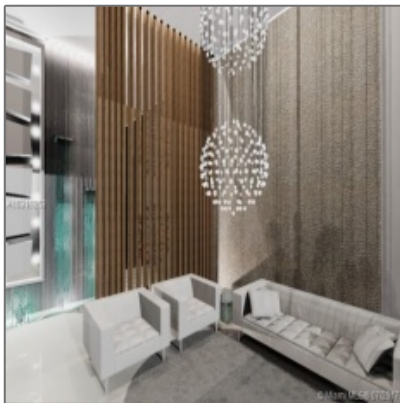

Basic [Details](#)

Tipo de Propiedad: **Commercial Property**

✓ Prop Type/Type of Building: **Retail space, Condominium**

Tipo de Listado: **For Sale**

ID del Listado: **A10316253**

Precio: **\$379,088**

Vista: **Garden view, other view**

Área del Solar: **919 Sqft**

Estado: **Active**

Address [Map](#)

País: **US**

Estado: **FL**

County: **Miami-Dade County**

Ciudad: **Doral**

Zipcode: **33172**

Building Name: **ELITE CENTRE AT DORAL**

Features

✓ Estacionamiento: **1, 7, 24**

Additional [Information](#)

Area: **30**

Parcel Number: **35-30-29-060-0080**

Tax Amount: **\$20,448**

Tax Year: **2016**

Zoning Information: **7600**

Elementary School: **Coconut grove**

Middle School: **Ponce de leon**

Senior High School: **Coral springs**

Price/SqFt: **\$413**

Lot Sq Footage: **919 Sqft**

Addresson Internet: **0**

Agent Info



Jiovanny Restrepo

📞 +1 (786) 760-1077

✉ mail@jio.realtor

+1 (786) 760-1077 - 1335 Lincoln Rd. Miami Beach, FL 33139
